

2001.0200K2M DATA SHEET
MODIFIED WITH LOW PROFILE OUTLET

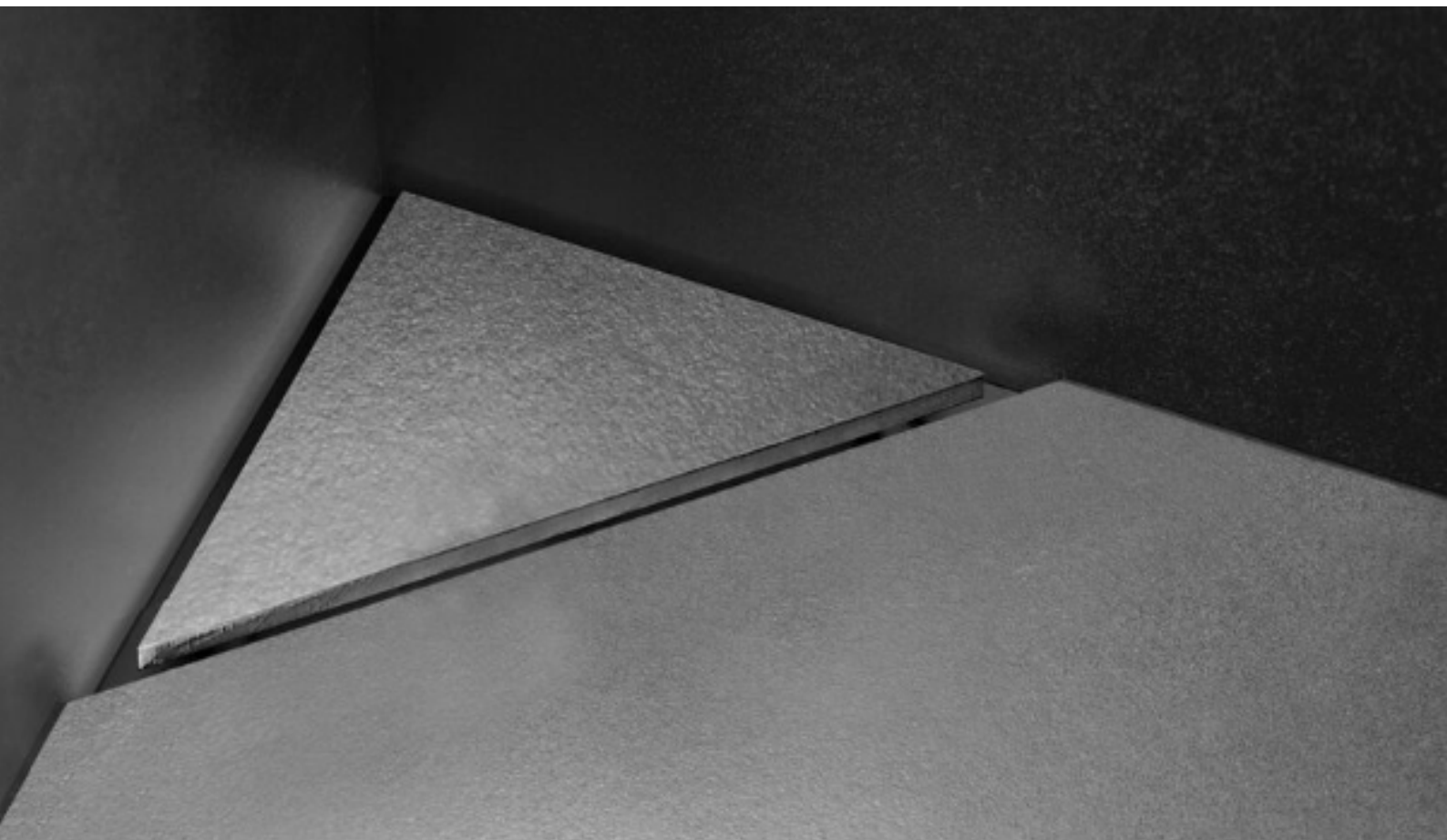

KIT CONTAINS

WALL MOUNTED
CORNER DRAIN
LOW PROFILE OUTLET
CLASSICLINE FRAME
CLASSIC GRATE

2011.0200

Corner 2011

The drain unit has two wall flanges and one floor flange.



Specifications

ITEM NUMBER	GTIN NUMBER	WEIGHT INCLUDING PACKAGING
2011.0200	5707692006659	900 g
WEIGHT EXCLUDING PACKAGING	MATERIAL	USAGE
700 g	1,5 mm stainless steel (AISI 304)	Corner drain
SURFACE	MEMBRANE	FLOOR CONSTRUCTION
Pickled	Liquid or sheet membrane	All
FLOORING	MOUNTING	INSTALLATION LENGTH (L1)
Tiles	6 mm plugs 6 mm screws. Torx 20	377 mm
INSTALLATION LENGTH (L2)		
267 mm		

DATA SHEET

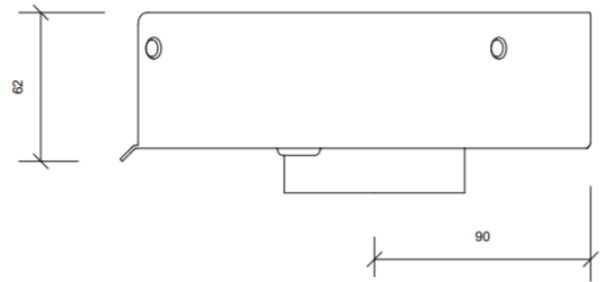
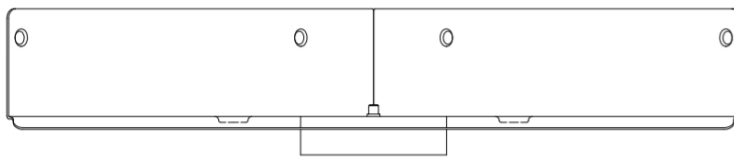
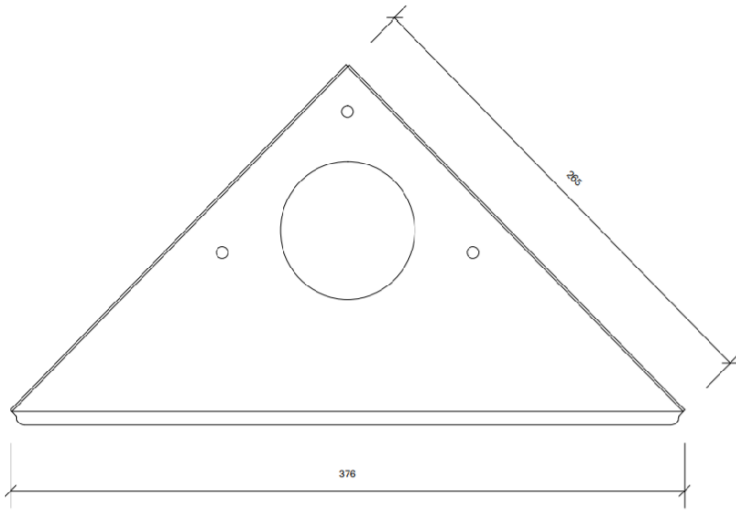

2011.0200

DATA SHEET

2415.0050

Line 2415 0050

Ø 50 mm horizontal drain

With removable odour barrier with effective self-cleaning effect

The odour barrier can be removed for cleaning. Can be rotated 360 degrees to facilitate pipework positioning

Note: Odour barrier is VA-approved



Specifications

ITEM NUMBER	GTIN NUMBER	WEIGHT INCLUDING PACKAGING
2415.0050	5707692006796	450 g
WEIGHT EXCLUDING PACKAGING	MATERIAL	USAGE
350 g	Plastic PP	Corner drain
BARRIER	GASKET	CAPACITY
With (odour barrier)	EPDM	0.5 l/s
SIDE INLET	CONSTRUCTION HEIGHT (CORNER)	FITS DRAIN UNIT
Without	72 mm	2011.0200

DATA SHEET

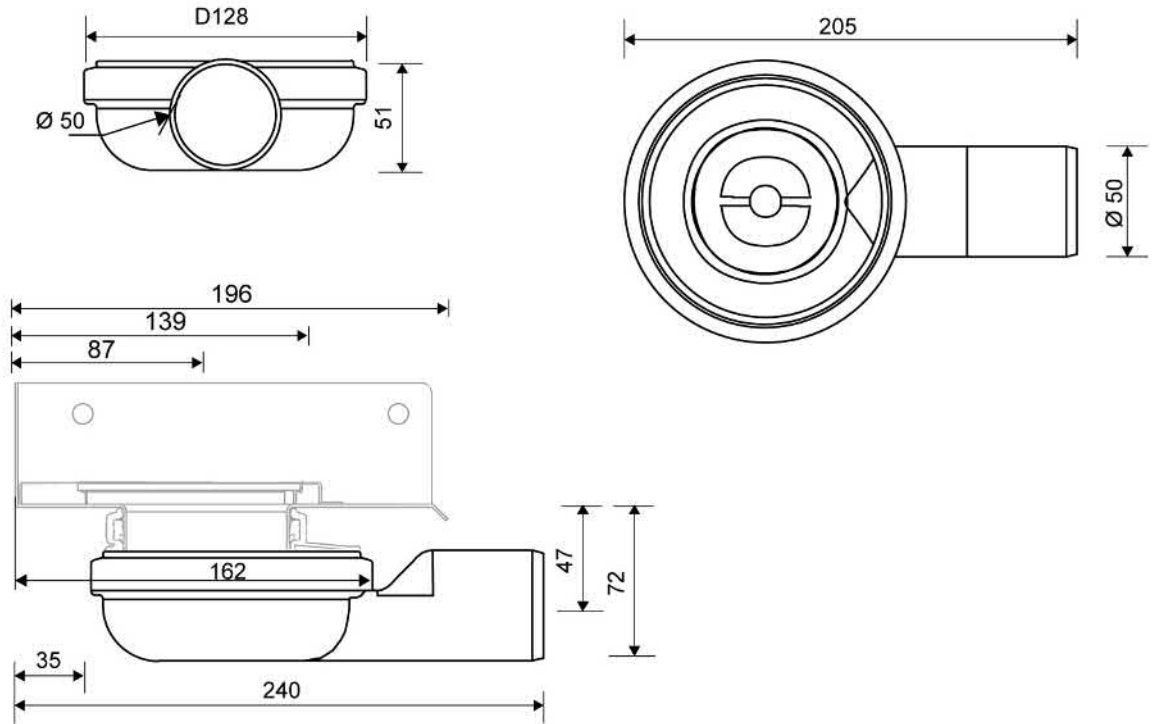

2415.0050

2950.0200

HighLine corner | CUSTOM

The set consists of a Custom base, rail, height adjusting set and screws. The set must be assembled before mounting. Can be installed with or without HighLine frame. Set includes 6 mm distance piece for use when mounting without a frame.



Specifications

ITEM NUMBER	GTIN NUMBER	WEIGHT INCLUDING PACKAGING
2950.0200	5707692009384	400 g
WEIGHT EXCLUDING PACKAGING	MATERIAL	USAGE
300 g	Stainless steel (AISI 304)	Corner drain
SURFACE	HEIGHTENER SET	
Brushed	Plastic (PE)	

DATA SHEET

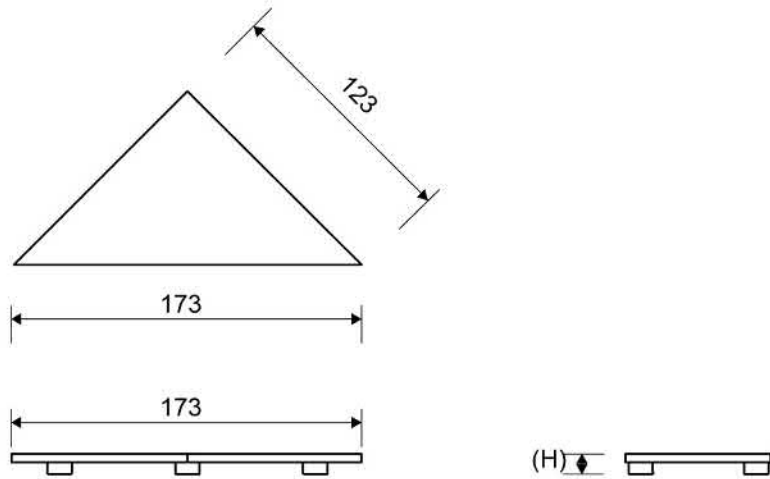

2950.0200