



AptLine® | Linear Installation

Kit Includes

- 48 Litres Per Minute
- 360° Outlet – 1½" Connection
- 50mm Water Seal
- Installation Feet
- Trimming & Tiling Guide
- Polished or Brushed Adjustable Panel
- 3.5m Membrane and Glue



Before installing
Ensure the drain is suitable for your requirements and you have all components to complete the installation

Important

Read all the pages of these instructions fully and thoroughly before you commence installation and keep in a safe location for future reference.

Plumbing

All plumbing works should be carried out by a fully qualified professional plumber.

Sub Floor

It is important that AptLine is installed onto a strong, level, stable floor. Movement could affect the performance of your wetroom.

Checklist/Safety Notes

- Check you have all components before installation. If you do not have all the components, do not install and contact your retailer.
- Check all the contents for damage. If any parts are damaged, do not install and contact your retailer.
- AptLine must be installed flat and horizontal.
- Check the location of pipes, electrical cables and all other services prior to drilling, cutting and screwing into walls, ceilings and floors.
- Ensure your tools for installation are fit for purpose and follow manufacturer's instructions provided with the tools.
- The area / room must be clean, dust free with first fix plumbing and electrics in place prior to applying the vinyl.
- Always ensure that the Installation area is kept safe, especially from children and pets.
- Safety goggles and masks should be worn at all times.

Liability

The Manufacturer will not accept any liability for failure if AptLine has been installed incorrectly and with disregard to the instructions.

AptLine® | Linear Installation

Unique system which provides ultimate flexibility. Metal drain and panel finish can be trimmed to size. Outlet can offset, height adjusted and is 360° rotational. Option of Polished or Brushed Stainless Steel panel. Suitable for any floor

Plan View

Side View

Model No.	Structural Length (A)	Visual Length (B)	Drain Depth (C)
800	870-350	800-350	85-105
1000	1070-800	1000-800	85-105

1

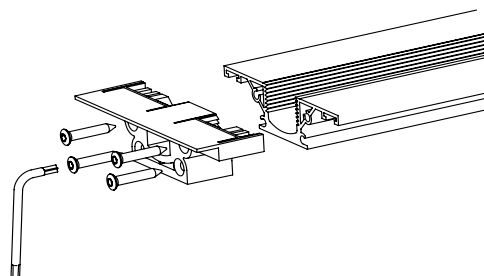
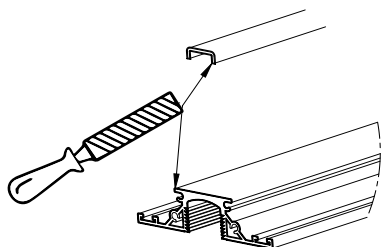
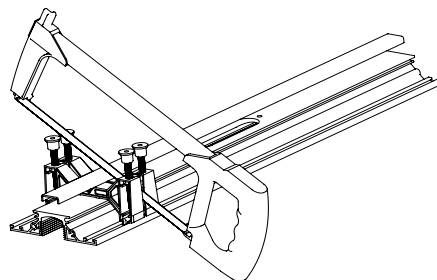
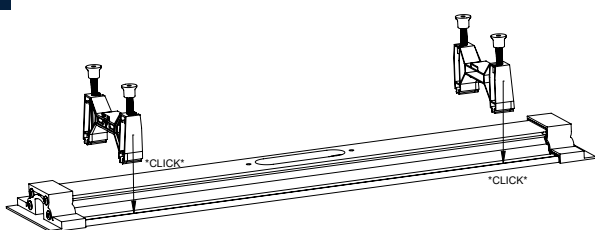

If required, cut down the drain to size. We recommend a sharp new blade, File ends smooth and reattach the end cap.

2

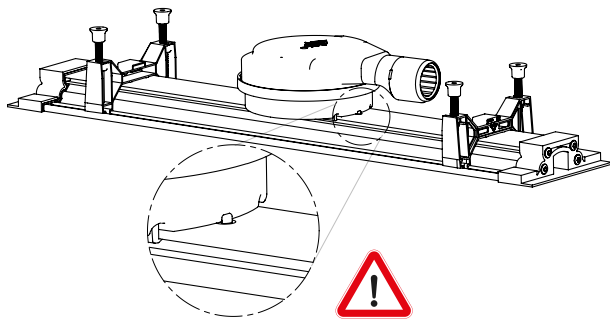
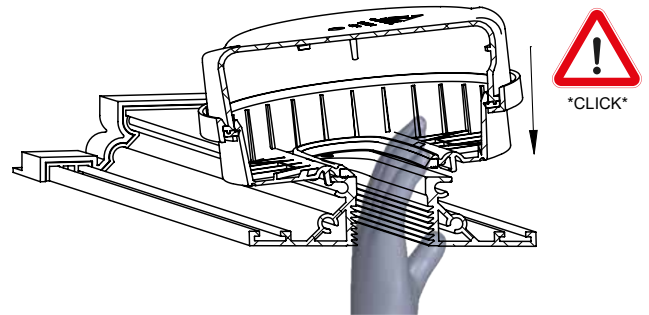
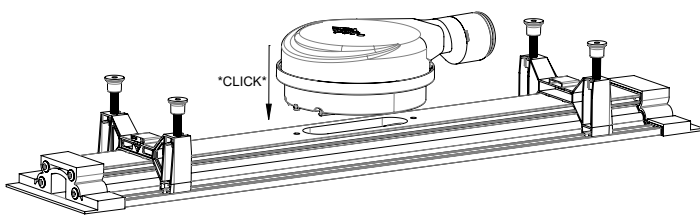

Attach outlet to the bottom of the drain. The black oval seal must be in place before.

3

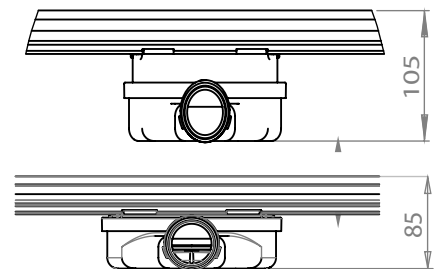
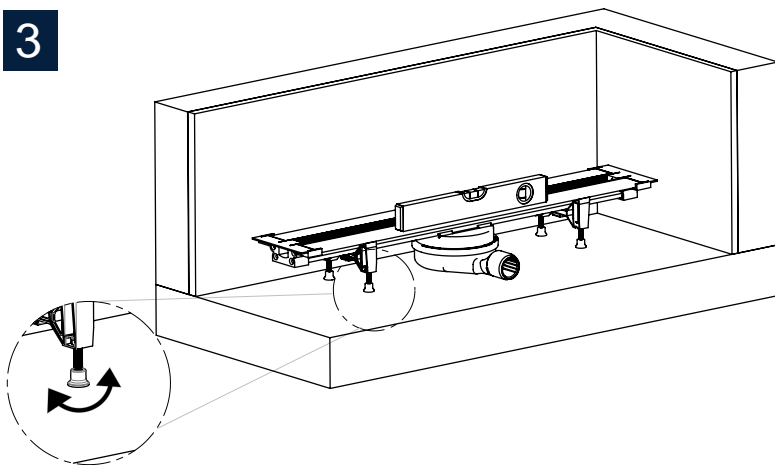

Ensure that the trap can be fully inserted before proceeding

Use adjustable feet to ensure that drain is at the correct height and is level. If required, reduce the height of the drain and cut the trap accordingly.

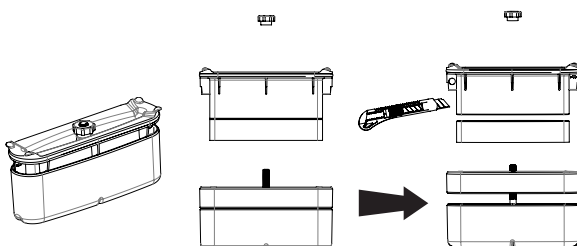

4

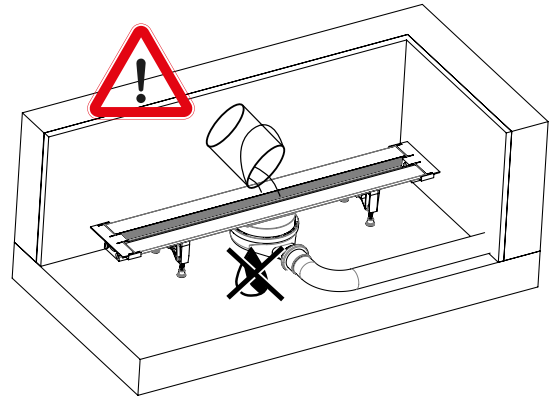
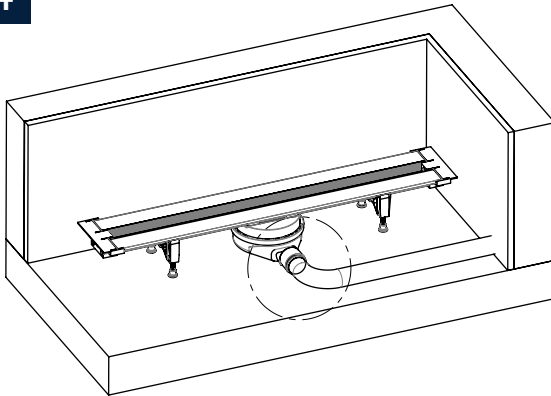

Connect pipework and test the connection is watertight by pouring water into the drain.

5

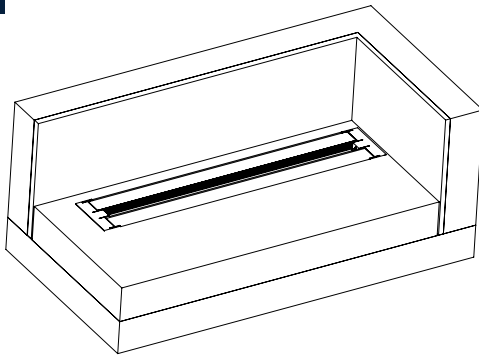

Create the fall to the drain. Ensure what the outlet is supported underneath. If using screed or concrete, ensure there are no voids underneath the drain.

6

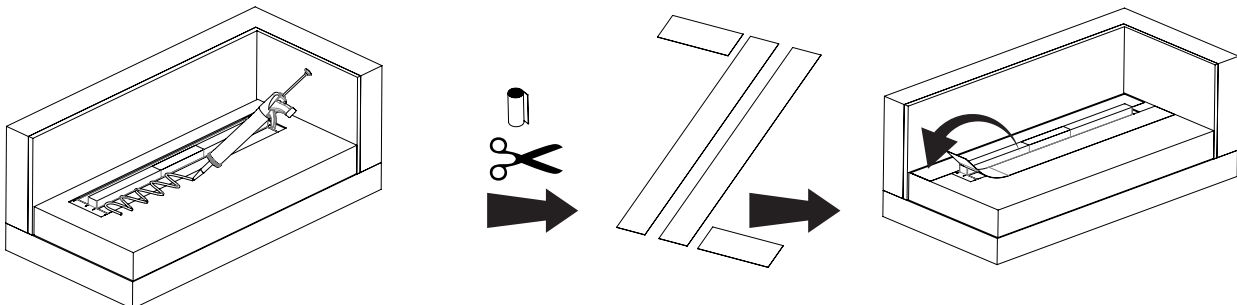

Insert polystyrene filler into the drain. Apply glue around the drain. Cut the reinforcement tape to size and apply onto glue. Carefully smooth down removing air bumps. Where overlapping tape, use glue. Waterproof floor and walls.

7

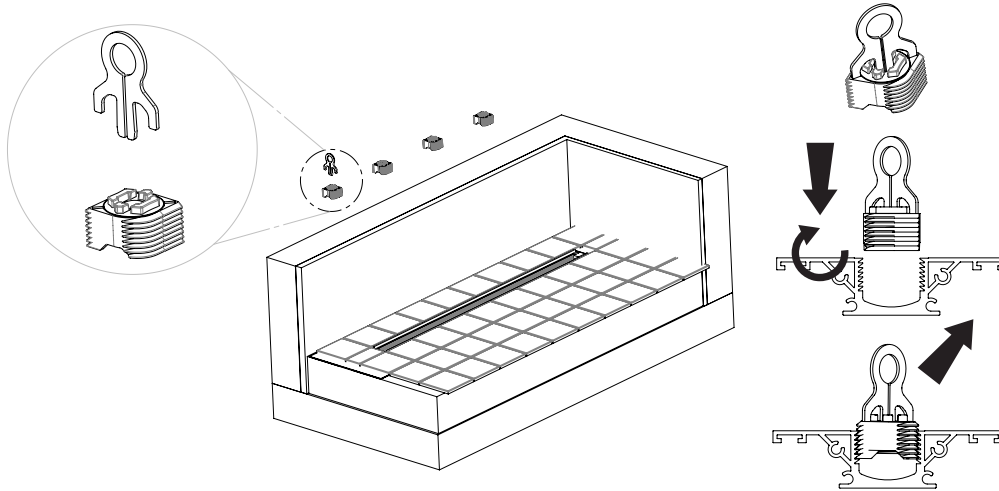

Tile floor and walls. Keep the polystyrene filler in place to use as a tiling guide. Use the adjustable panel supports to adjust the panel which will be placed into the drain so it is flush with the tiles.

8

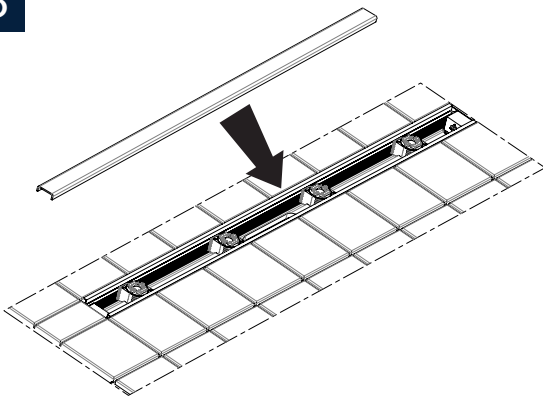

Place panel into the drain.

AptLine® | Linear Installation

It is essential to clean your wetroom drain regularly to prevent blockages and maintain performance and longevity. To clean, remove the panel and trap. Disassemble the trap and rinse. Reassemble the trap and place back into the drain. Do not use any harsh cleaning products as this can damage the drain / pipework.

Cleaning & Maintenance

